

**Sections, General Notes:**

- Unless labelled as "existing", assume features are to be newly constructed. (Refer to foundation and roof plans for the general boundaries of what is existing and what is to be newly constructed.)
- Elevations are with respect to:
  - line marked "A", top edge of existing subfloor in the great room
  - line marked "B", top edge of existing tile floor in entry
  - line marked "C", top edge of existing concrete floor in lower level
 Note: assume finished floor elevations are 3/4" above these floor elevations.

**Legend**

- wood framing
  - concrete
- [WD--] Window or Door labels are attached to window/door width. Note that width indicates the rough opening. See schedules on page A601.

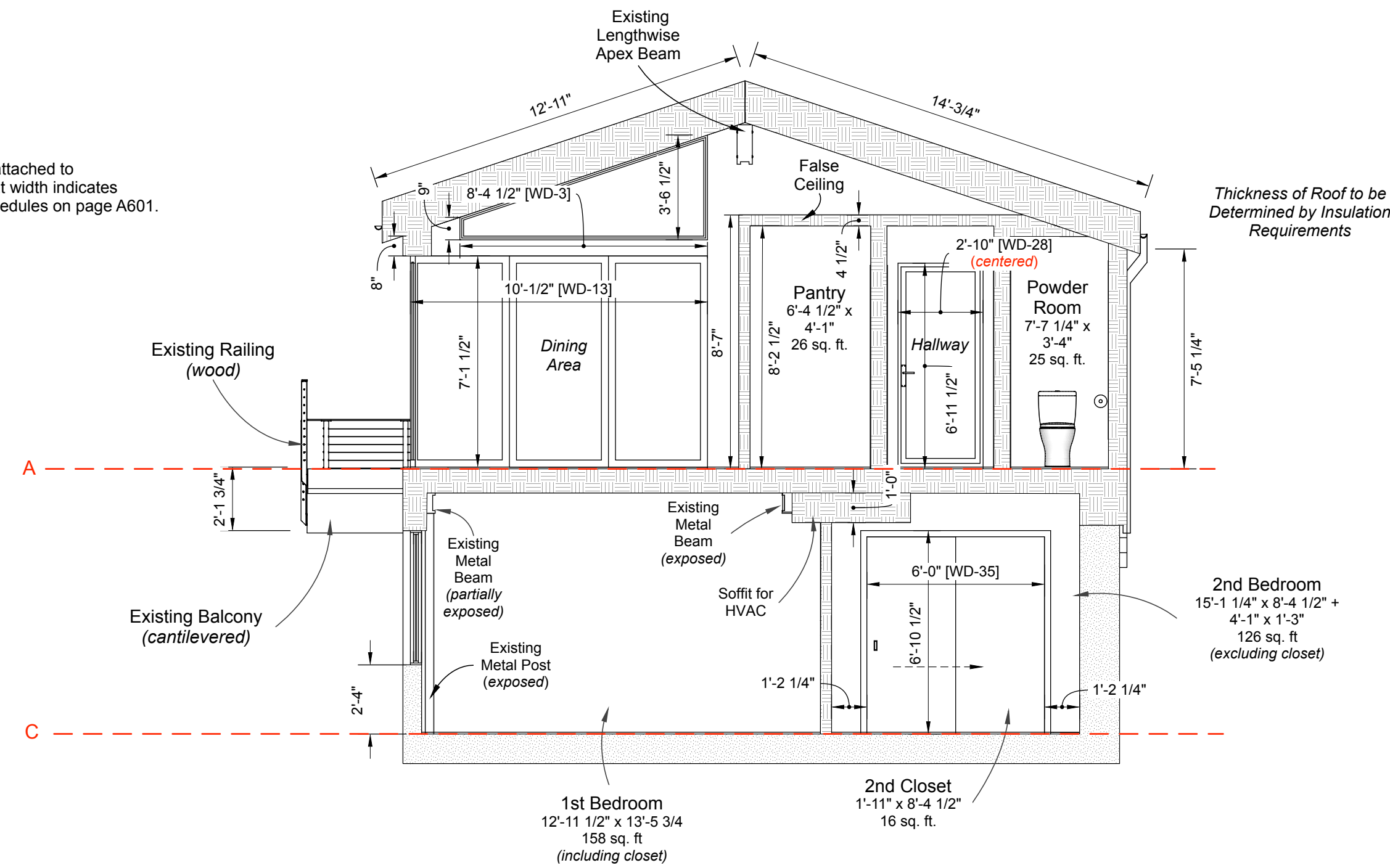

South Facing Section I  
\*drawing scale 1/4" = 1'-0"  
A303  
1

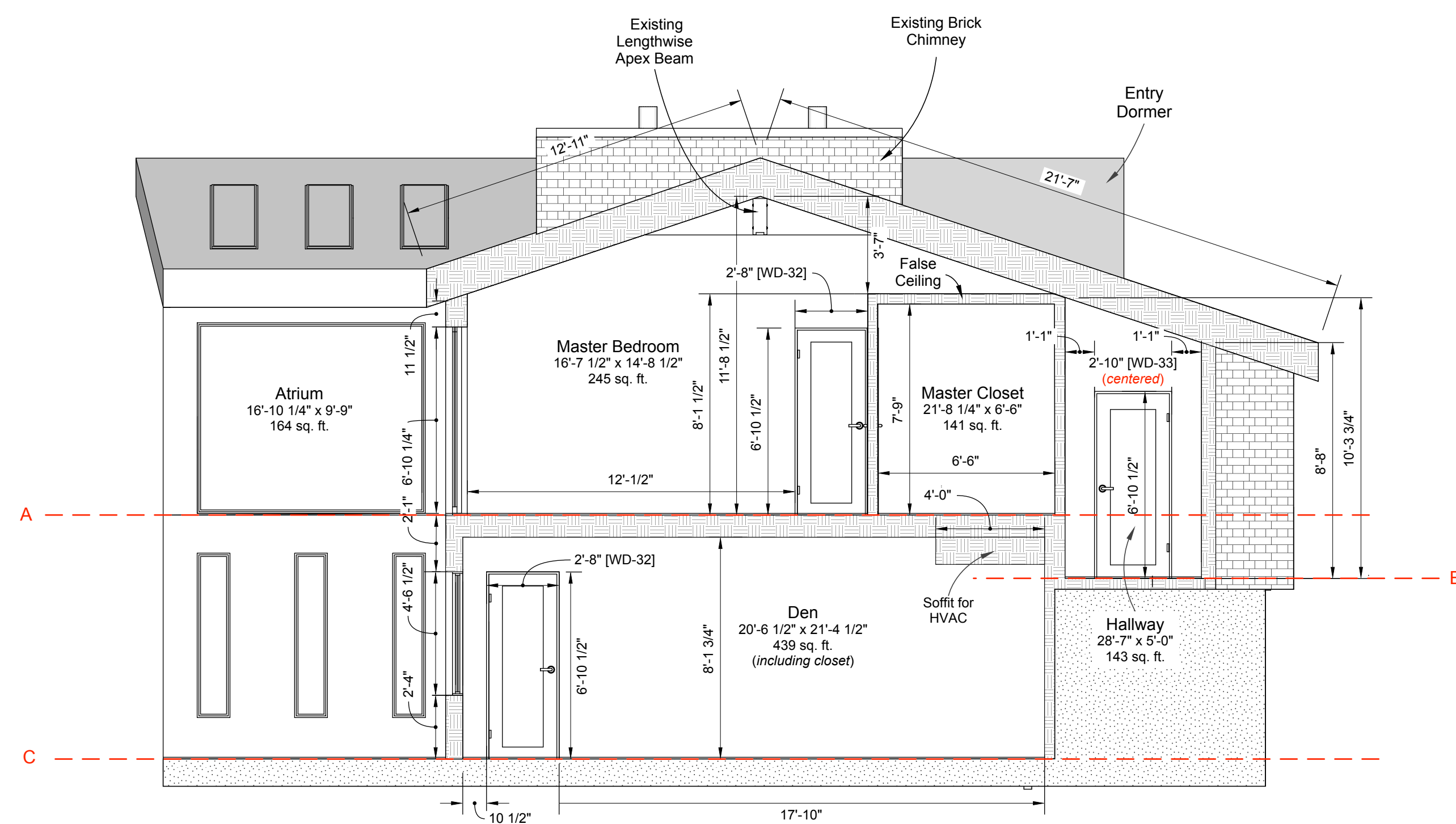

South Facing Section III  
\*drawing scale 1/4" = 1'-0"  
A303  
3

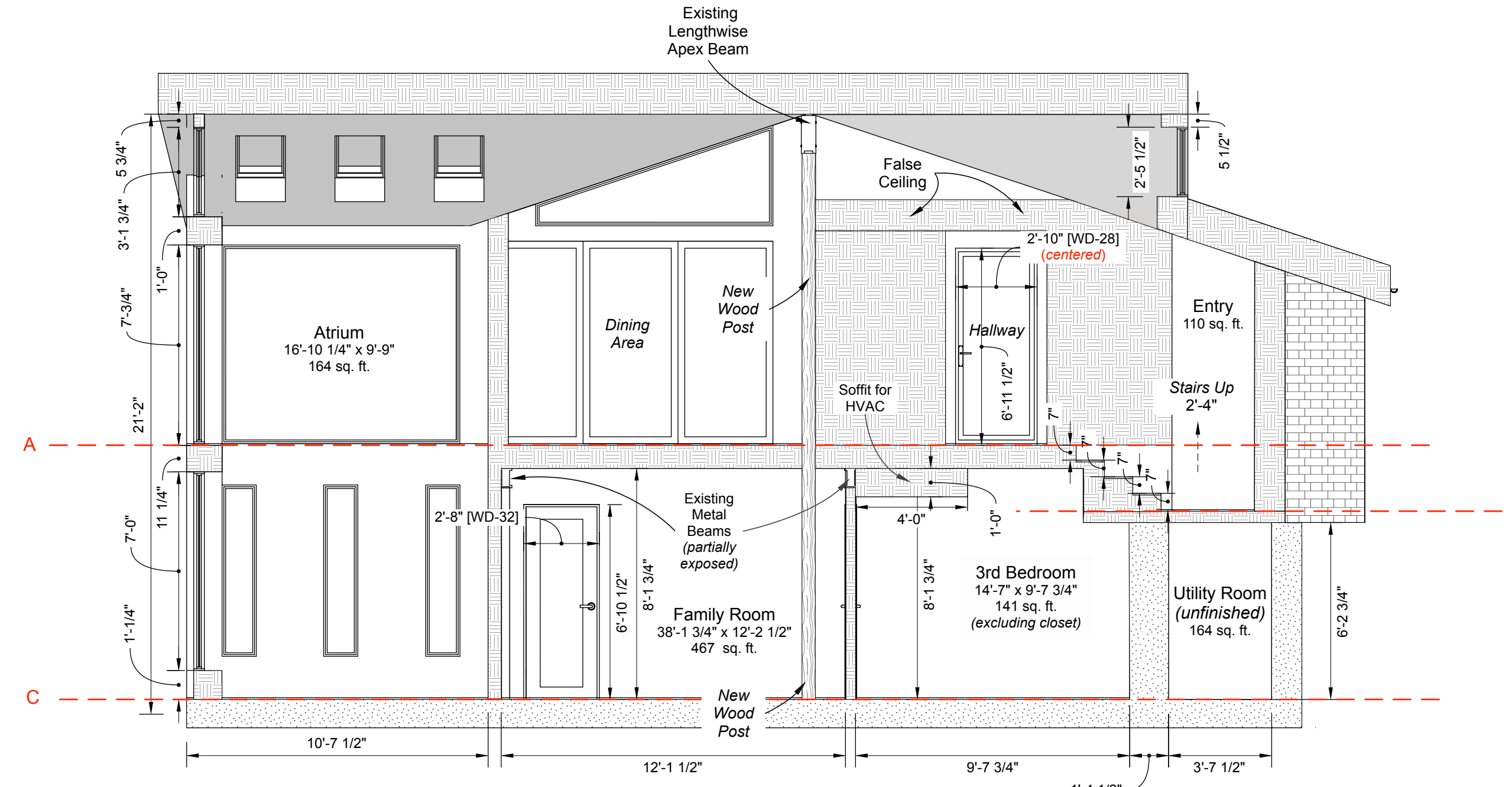

South Facing Section II  
\*drawing scale 1/4" = 1'-0"  
A303  
2

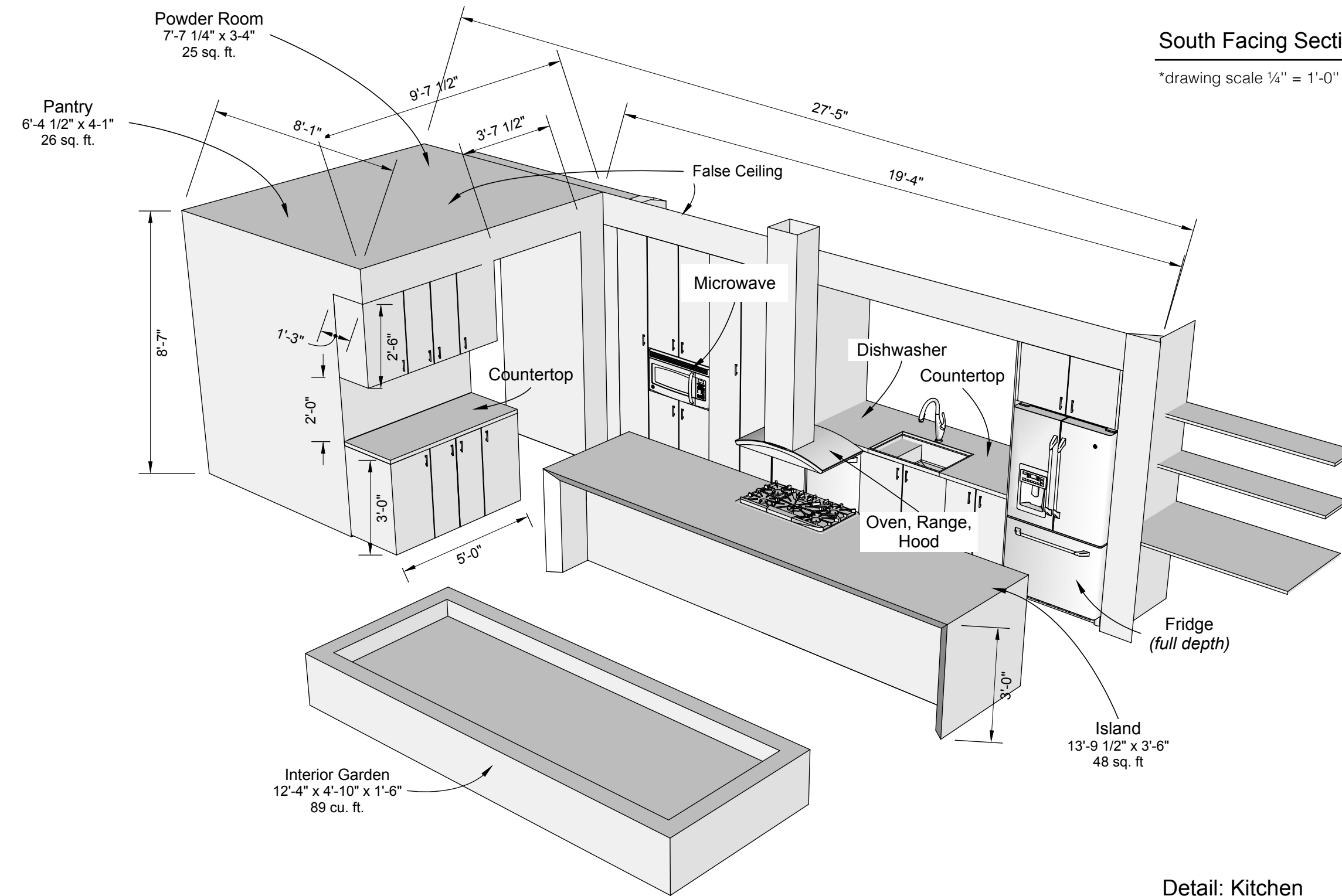

Detail: Kitchen  
A303  
6

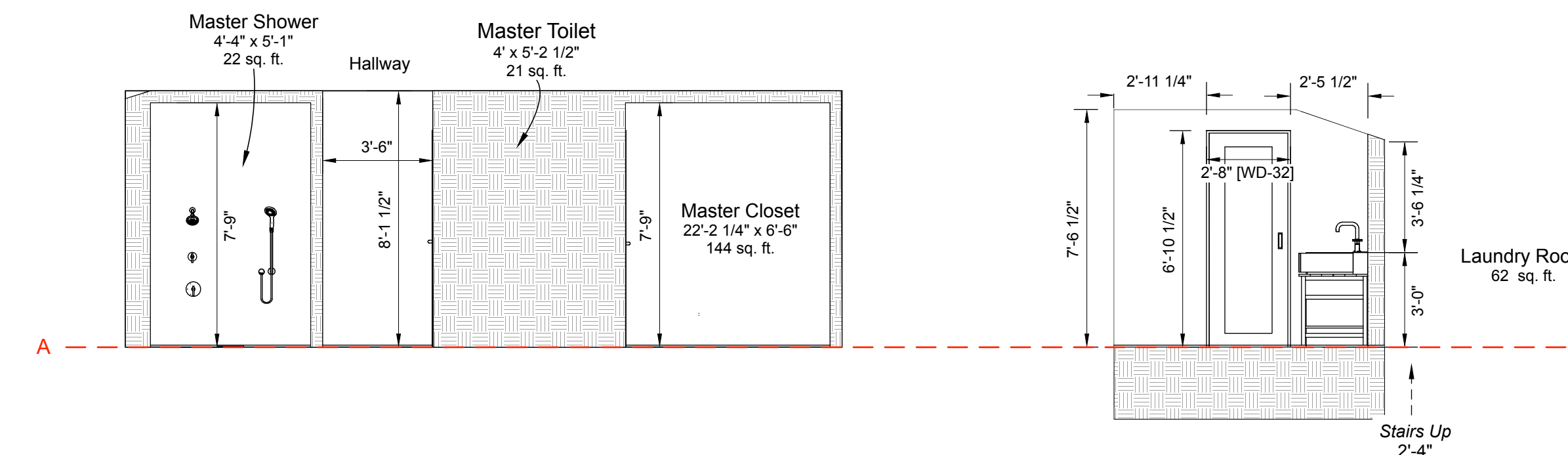

South Facing Section IV:  
Master Shower & Toilet  
\*drawing scale 1/4" = 1'-0"  
A303  
4

South Facing Section V:  
Laundry Room  
\*drawing scale 1/4" = 1'-0"  
A303  
5



**Design By:**  
Riedel-Fall Designs  
200 Union St. S.E.  
Minneapolis, MN 55455  
Tel: 612-275-9878

**Design for:**  
Dr. Marc Riedel & Mrs. Emery Fall  
5995 Ridge Rd.  
Shorewood, MN 55331  
Tel: 612-275-9878

Date	Revision	By
9/11/17	Initial Drawings	MDR, EKF
11/29/17	Atrium, Entry	MDR, EKF
5/7/18	Skylights, Foundations	MDR, EKF
7/3/18	Brick Entry	MDR, EKF
1/14/19	Permit Set/Windows	MDR, EKF
3/21/19	Initial Construction Set	MDR, EKF
4/3/19	Revised Construction Set	MDR, EKF
4/28/19	Final Construction Set	MDR, EKF

**DATE SUBMITTED**  
04.28.19

**DRAWN BY**  
MDR, EKF

**A303 South-Facing Sections; Kitchen Details**

**A303**