

Standard Erosion Control Notes for RPBCWD Development Reviews

C1. The erosion control plan must include the following notes:

- Natural topography and soil conditions must be protected, including retention onsite of native topsoil to the greatest extent possible.
- Additional measures, such as hydraulic mulching and other practices as specified by the District must be used on slopes of 3:1 (H:V) or steeper to provide adequate stabilization.
- Final site stabilization measures must specify that at least six inches of topsoil or organic matter be spread and incorporated into the underlying soil during final site treatment wherever topsoil has been removed.
- Construction site waste such as discarded building materials, concrete truck washout, chemicals, litter and sanitary waste must be properly managed.
- All temporary erosion and sediment control BMPs must be maintained until completion of construction and vegetation is established sufficiently to ensure stability of the site, as determined by the District.
- All temporary erosion and sediment control BMPs must be removed upon final stabilization.
- Soil surfaces compacted during construction and remaining pervious upon completion of construction must be decompacted to achieve a soil compaction testing pressure of less than 1,400 kilopascals or 200 pounds per square inch in the upper 12 inches of the soil profile while taking care to protect utilities, tree roots, and other existing vegetation.
- All disturbed areas must be stabilized within 7 calendar days after land-disturbing work has temporarily or permanently ceased on a property that drains to an impaired water, within 14 days elsewhere.
- The permittee must, at a minimum, inspect, maintain and repair all disturbed surfaces and all erosion and sediment control facilities and soil stabilization measures every day work is performed on the site and at least weekly until land-disturbing activity has ceased. Thereafter, the permittee must perform these responsibilities at least weekly until vegetative cover is established. The permittee will maintain a log of activities under this section for inspection by the District on request.

AIS Note for RPBCWD Development Reviews (Rules B, D, E, F, G)

Activities must be conducted so as to minimize the potential transfer of aquatic invasive species (e.g., zebra mussels, Eurasian watermilfoil, etc.) to the maximum extent possible.

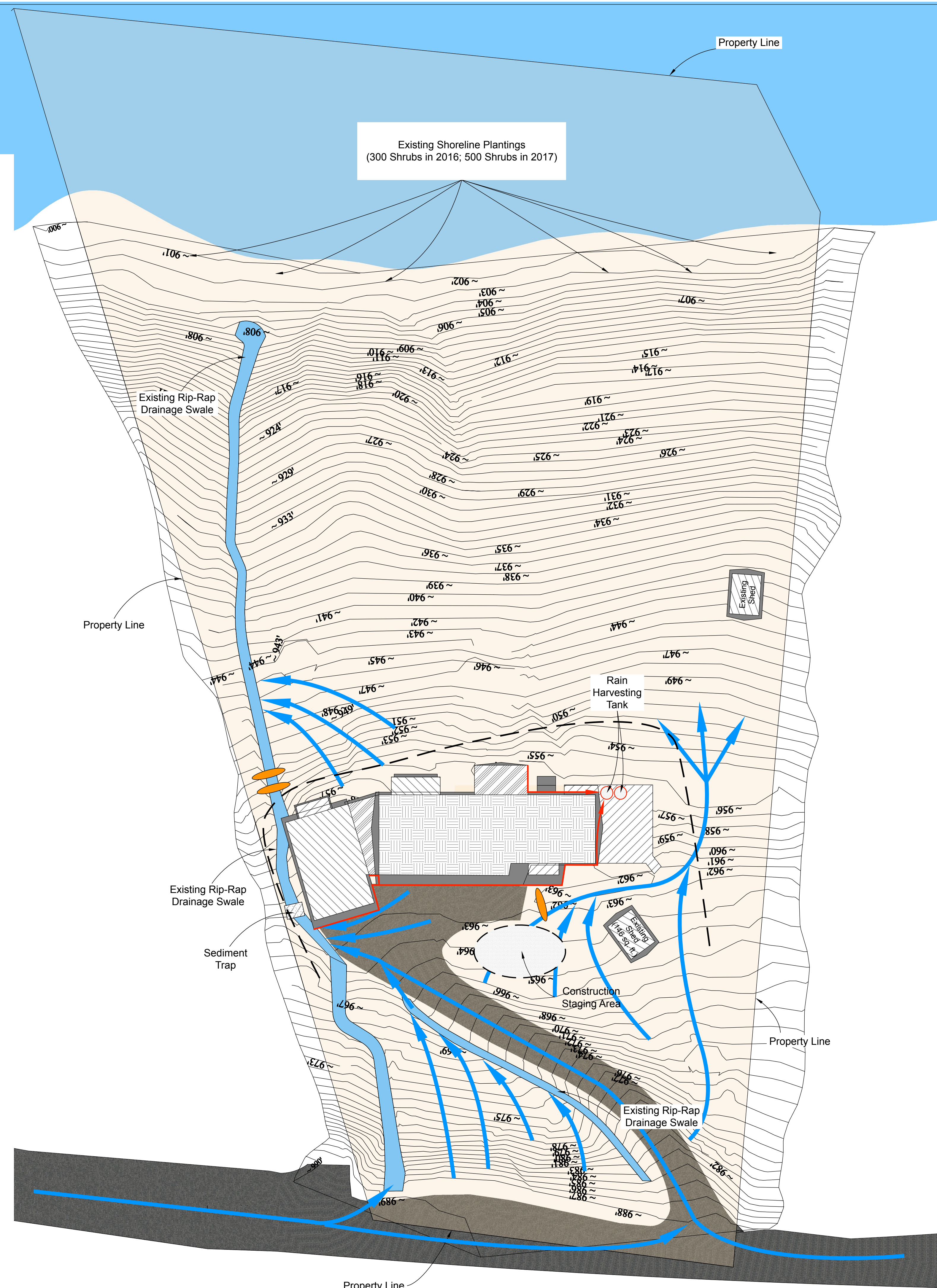

Legend

- Drainage Swales
- Drainage Paths
- Underground pipes directing water from gutters.
- Rainwater cistern connected to existing irrigation system
- Erosion Control: Silt Fence
- Construction Staging Area
- Biorolls or Rock Logs

Site Plan
*drawing scale 1" = 20'

V102
1



Design By:
Riedel-Fall Designs
200 Union St. S.E.
Minneapolis, MN 55455
Tel: 612-275-9878

Design for:
Dr. Marc Riedel & Ms. Emery Fall
5995 Ridge Rd.
Shorewood, MN 55331
Tel: 612-275-9878

Date	Revision	By
01/17/17	Final Drawings	MDR, EKF
11/29/17	Attn: Entry	MDR, EKF
5/7/18	Skylights, Foundations	MDR, EKF
7/3/18	Brick Entry	MDR, EKF
1/14/19	Permit Set	MDR, EKF
3/21/19	Initial Construction Set	MDR, EKF
4/23/19	Revised Construction Set	MDR, EKF
4/28/19	Final Construction Set	MDR, EKF

DATE SUBMITTED
04.28.19

DRAWN BY
MDR, EKF

V102 Drainage Plan and Stormwater Management

V102