

Floor Plans, General Notes:

- Unless labelled as "existing", assume features are to be newly constructed. (Refer to foundation and roof plans for the general boundaries of what is existing and what is to be newly constructed.)

Exterior Walls	Interior Walls
4" walls are dimensioned at 7.5" thick: 1/2" sheetrock 3 1/2" stud 1/2" sheathing 1 1/2" rigid foam 3/4" furring strip 3/4" wood siding/brick veneer	4" walls are dimensioned at 4.5" thick: 1/2" sheetrock 3 1/2" stud 1/2" sheetrock plumbing walls are dimensioned at 6.5" thick: 1/2" sheetrock 5 1/2" stud 1/2" sheetrock
6" walls are dimensioned at 9.5" thick: 1/2" sheetrock 5 1/2" stud 1/2" sheathing 1 1/2" rigid foam 3/4" furring strip 3/4" wood siding/brick veneer	
8" walls are dimensioned at 11.5" thick: 1/2" sheetrock 7 1/2" stud 1/2" sheathing 1 1/2" rigid foam 3/4" furring strip 3/4" wood siding/brick veneer	

Width of bridge section to be adjusted according to actual location of north wall, with side yard setback.

Window and lean-to shed to be centered on garage addition.

Floor Above 4th Bedroom to be Insulated and Non-Combustible (per R309.2)

Finished wall to be a minimum of 3" from side yard setback line

outer edge of exterior finished wall
outer edge of sheathing
inside edge of sheetrock

Legend
 Section, shown on corresponding page.
 [WD-1] Window or Door labels are attached to window/door width. Note that width indicates the rough opening. See schedules on page A601.

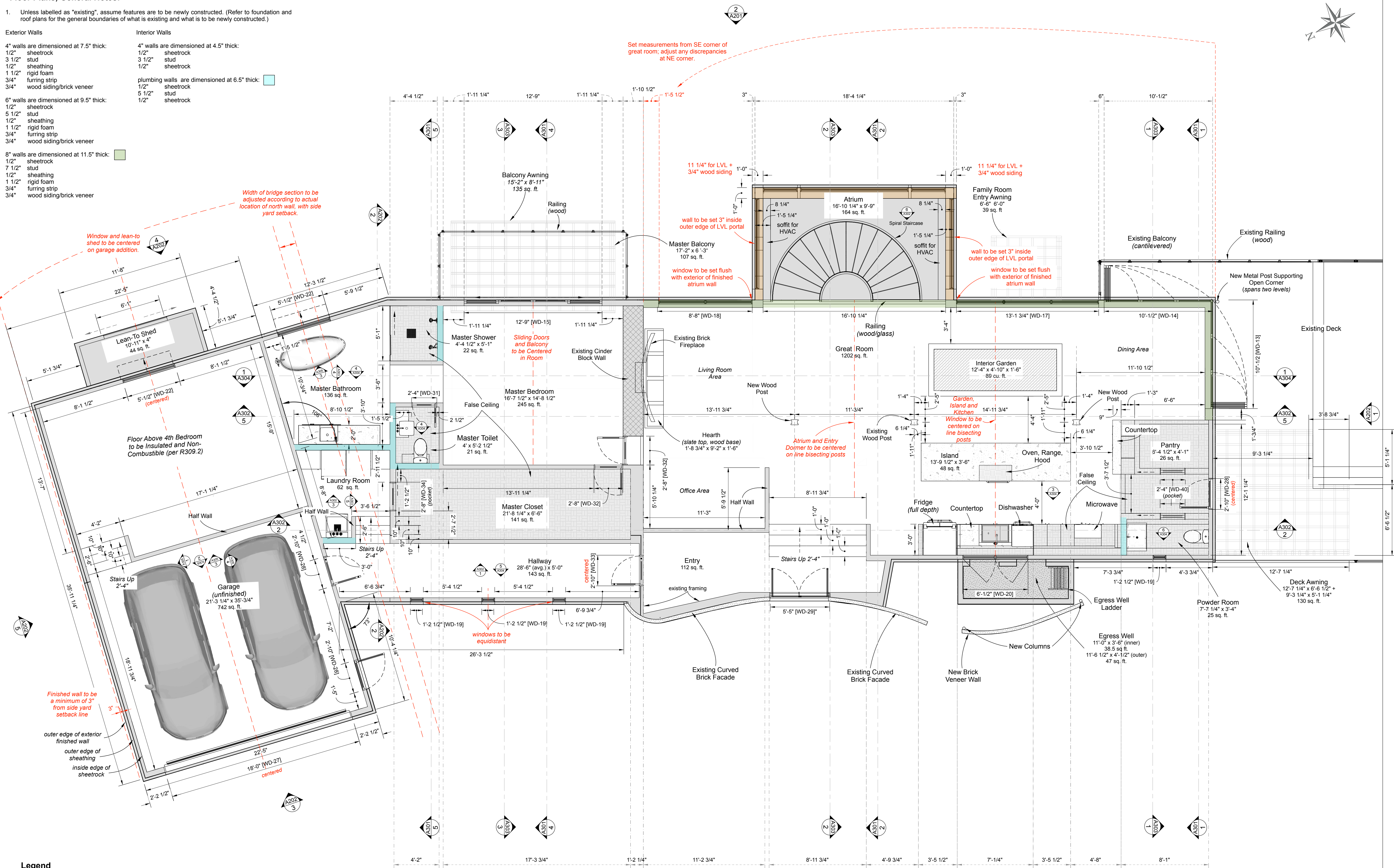

Set measurements from SE corner of great room; adjust any discrepancies at NE corner.

11 1/4" for LVL + 3/4" wood siding

wall to be set 3" inside outer edge of LVL portal

window to be set flush with exterior of finished atrium wall

11 1/4" for LVL + 3/4" wood siding

wall to be set 3" inside outer edge of LVL portal

window to be set flush with exterior of finished atrium wall

Atrium and Entry Dome to be centered on line bisecting posts

Garden, Island and Kitchen Window to be centered on line bisecting posts

windows to be equidistant

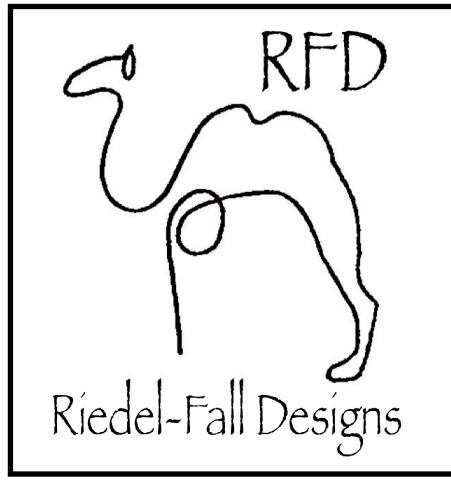

Design By:
Riedel-Fall Designs
 200 Union St. S.E.
 Minneapolis, MN 55455
 Tel: 612-275-9878

Design for:
Dr. Marc Riedel & Mrs. Emery Fall
 5995 Ridge Rd.
 Shorewood, MN 55331
 Tel: 612-275-9878

Date	Revision	By
01/17/17	Final Drawings	MDR, EKF
11/29/17	Atrium, Entry	MDR, EKF
5/7/18	Skylights, Foundations	MDR, EKF
7/3/18	Brick Entry	MDR, EKF
1/14/19	Permit Set/Drawings	MDR, EKF
3/21/19	Initial Construction Set	MDR, EKF
4/3/19	Revised Construction Set	MDR, EKF
4/28/19	Final Construction Set	MDR, EKF

DATE SUBMITTED
 04.28.19

DRAWN BY
 MDR, EKF

A102 Upper Level Floorplan

Upper Level Floorplan
 "drawing scale 1/4" = 1'-0"
 A102
 1

A102